

## REASSEMBLY

### NOTICE:

When using a vise, do not overtighten it.

#### 1. INSTALL TILT AND TELESCOPIC ECU

Install the tilt and telescopic ECU with the 2 screws.

#### 2. INSTALL NO. 2 BRACKET

Install the No. 2 bracket with the bolt.

#### 3. INSTALL NO. 1 BRACKET

Install the No. 1 bracket with the bolt.

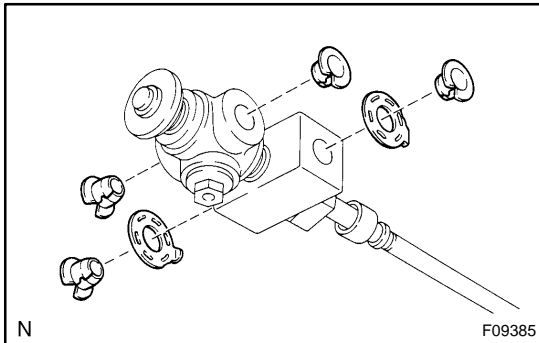

#### 4. INSTALL TILT SLIDER ASSEMBLY

- (a) Install 2 new plates and 4 new bushings to the tilt slider assembly in the direction shown in the illustration.

### HINT:

Install the bushings with their cuts facing downward.

- (b) Using a hexagon wrench, install the tilt slider assembly with the 2 washers and 4 bolts.

**Torque: 23 N·m (230 kgf-cm, 17 ft-lbf)**

### HINT:

- When replacing a tilt slider assembly with new one, apply grease on the removed tilt slider assembly to the shaft of the new tilt slider assembly.
- Install the tilt slider assembly with the bolt portion of the tilt slider faced downward.
- Do not let the grease be stuck on the thread part of the bolt in order to prevent the bolt from slipping.

#### 5. INSTALL TURN SIGNAL BRACKET

Install the turn signal bracket with the 3 bolts.

#### 6. INSTALL COLUMN TUBE SUPPORT

### NOTICE:

If the attachment or support is deformed, replace it with a new one.

- (a) Install the tube attachment to the column tube support.  
(b) Install the column tube support with the bolt.

**Torque: 20 N·m (200 kgf-cm, 14 ft-lbf)**

### NOTICE:

Make sure that the tube support is installed facing in the correct direction (See page [SR-9](#)).

- Tighten the bolt while holding the support to prevent it turning too.
- Be sure to tighten the bolt with the specified torque.

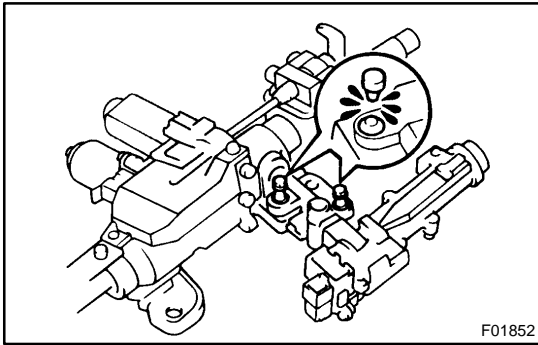
**7. INSTALL COLUMN UPPER BRACKET**

- (a) Install the column upper bracket with 2 new tapered-head bolts.
- (b) Tighten the 2 tapered-head bolts until the bolt heads break off.

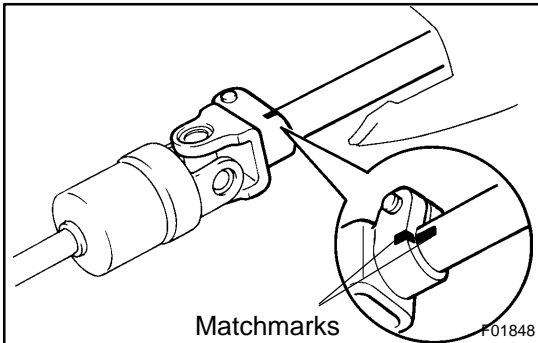
**8. INSTALL NO. 2 INTERMEDIATE SHAFT ASSEMBLY**

- (a) Align the matchmarks on the No. 2 shaft and main shaft.
- (b) Install the bolt.

**Torque: 35 N·m (360 kgf·cm, 26 ft·lbf)**

**9. INSTALL KEY CYLINDER ILLUMINATION****10. INSTALL TRANSPONDER KEY COIL**

Install the transponder key coil with the screw.